

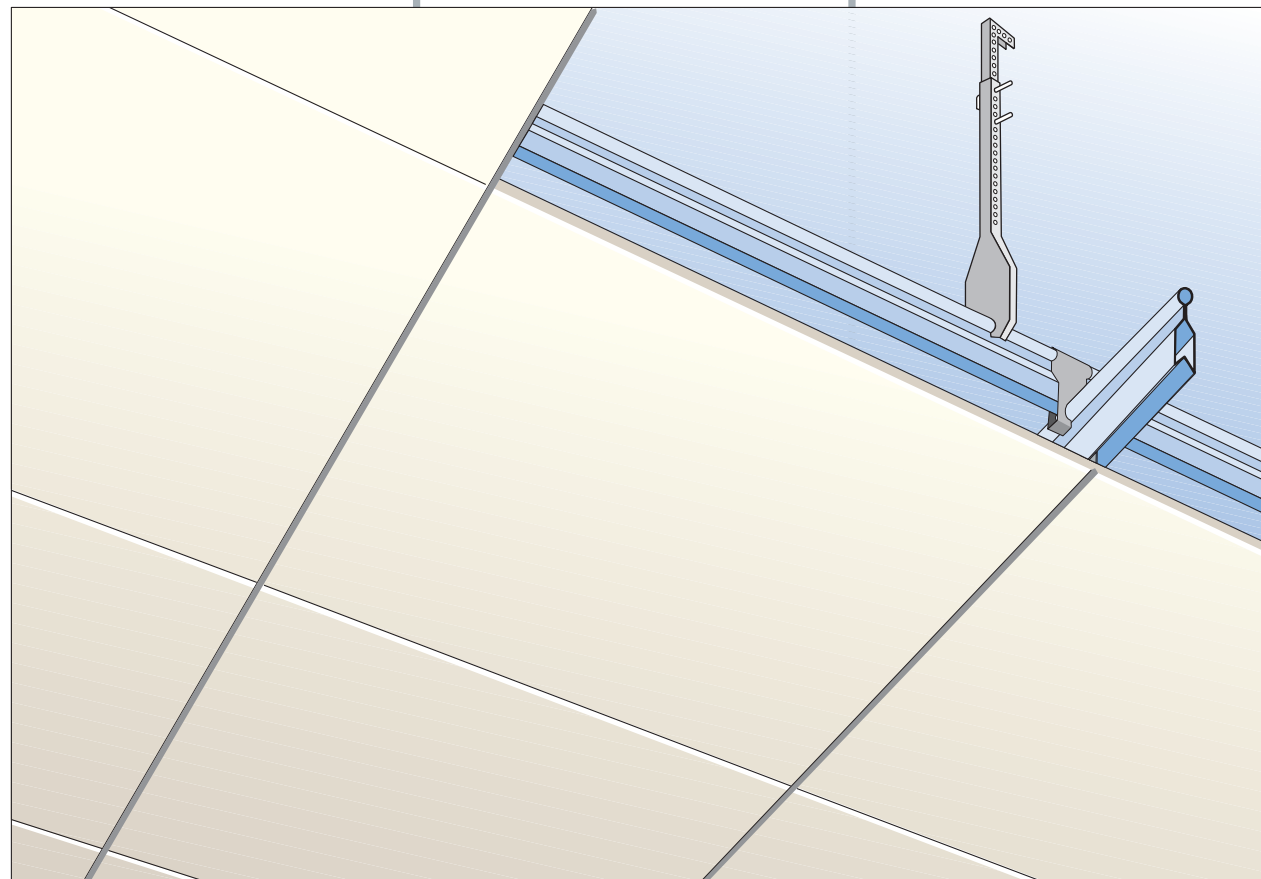

ShanghaiProfil

Tilux

METAL CEILING TILES
(Clip-in / Flap-down system)



1A
&
1B

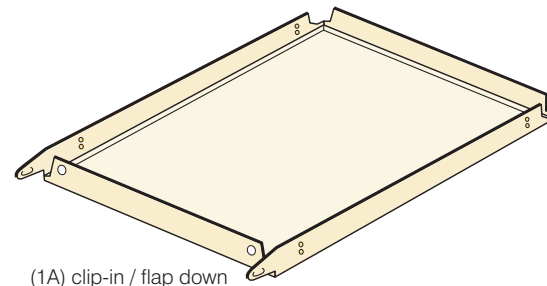

(1A) clip-in / flap down

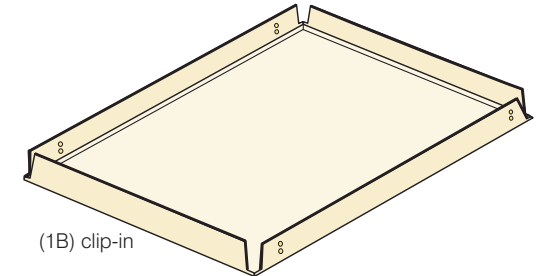

(1B) clip-in

Press formed aluminium or steel in thicknesses shown in Table 2, clip in flap down (1A) (only C600) or clip in (1B). Perforated tiles to have black tissue lining bonded to rear of tile see item (4).

Table 2
Legend:

W = profile width mm
H = profile height mm
Al = aluminium thickness mm
St = steel thickness mm

Ref.	W	L	H	Al
C600	600	600	23.5	0.7
C500	500	500	23.5	0.7
C300	300	300	23.5	0.4
C300x1200	300	1200	23.5	0.7
C300x600	300	600	23.5	0.7
C600x1200	600	1200	23.5	0.8

Standard finish: stove enamel polyester paint in matt, semi-gloss or full gloss.
Standard colour: white similar RAL9010.
Special finishes: subject to minimum order quantity.

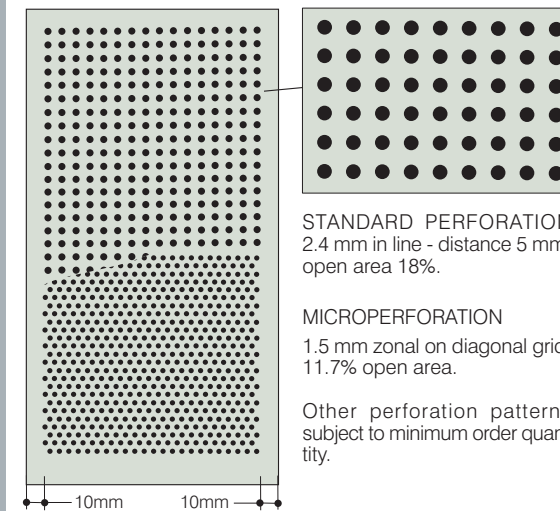

STANDARD PERFORATION
2.4 mm in line - distance 5 mm, open area 18%.

MICROPERFORATION
1.5 mm zonal on diagonal grid, 11.7% open area.

Other perforation patterns subject to minimum order quantity.

2i
&
2ii

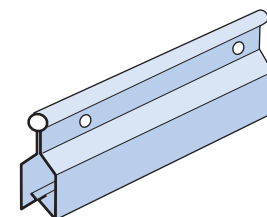

Split base main runners (2i) and primaries (2ii) (identical) cold roll formed 0.6mm thick galvanised steel.
Standard lengths: 4000mm.
Overall size: 38.5mm deep x 16mm wide.

2A

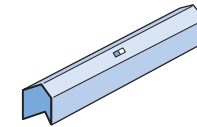

Vee coupler for main runners and primaries in 0.6mm thick galvanised mild steel x 100mm long.

2B

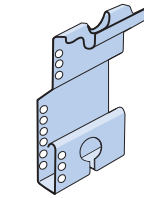

Clip bracket out of 0.6mm galvanised mild steel 30mm wide x 50mm deep.

3A

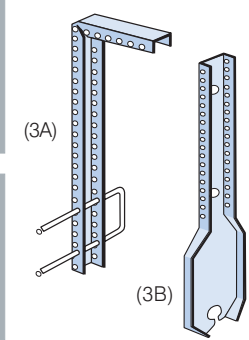

Upper section VERNIER hanger in 1.0 mm thick galvanised mild steel, with 3 mm dia. steel looped security pin.
Standard length: 2000 mm (cut and bend on site to suit ceiling void depth).

3B

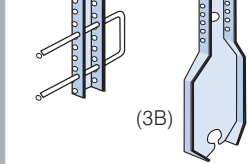

Suspension bracket manufactured in 2 mm thick galvanised mild steel.

4

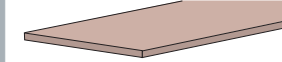

Perforated tiles to have black tissue lining bonded to rear of tile.
Insulation pads fitted in tile on site when specified.
Standard 30 mm thick 55kg/m³ with black tissue face (acoustical properties available).

5

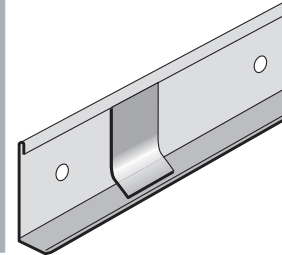

Perimeter angle trim in cold roll formed 0.6 mm thick galvanised mild steel.
Standard finish: white or black semi gloss stove enamel polyester paint.
Standard length: 4000 mm.
Overall size: 40 mm deep x 20 mm wide.

6

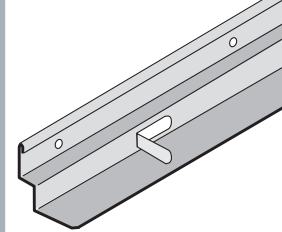

Perimeter shadow line angle trim in steel, finish and lengths as (5).
Overall size: 44 mm deep x 36.5 mm wide (24 x 12.5 x 20 x 24 mm). Shadow gap width = 12.5 mm.

26

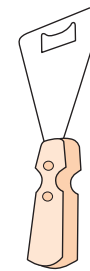

Steel blade joint penetration tool used to disengage tile from main runners.

ShanghaiProfil Metal Ceiling Co., Ltd.
No. 30, Lane 1125, Nanliu Road,
Pudong New Area, 201300 Shanghai
P.R. China

Tel: (+86)-21-5803 3985
E-mail: info@shanghaiprofil.com
Fax: (+86)-21-5803 3990
Internet: www.shanghaiprofil.com

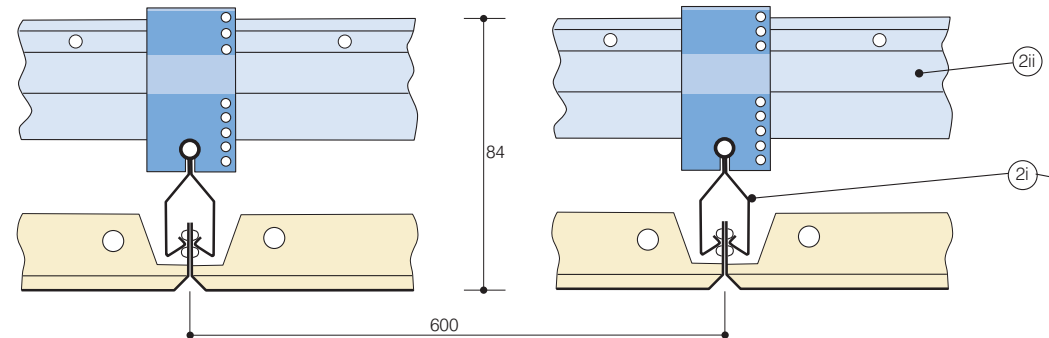

Fig.1 TILUX main runner (2i) in cross section.

Suspended from the structural soffit by adjustable hangers (3A) & (3B), primary member (2ii) support main runners (2i), which are attached to the primaries at 600mm centres using the clip brackets (2B).

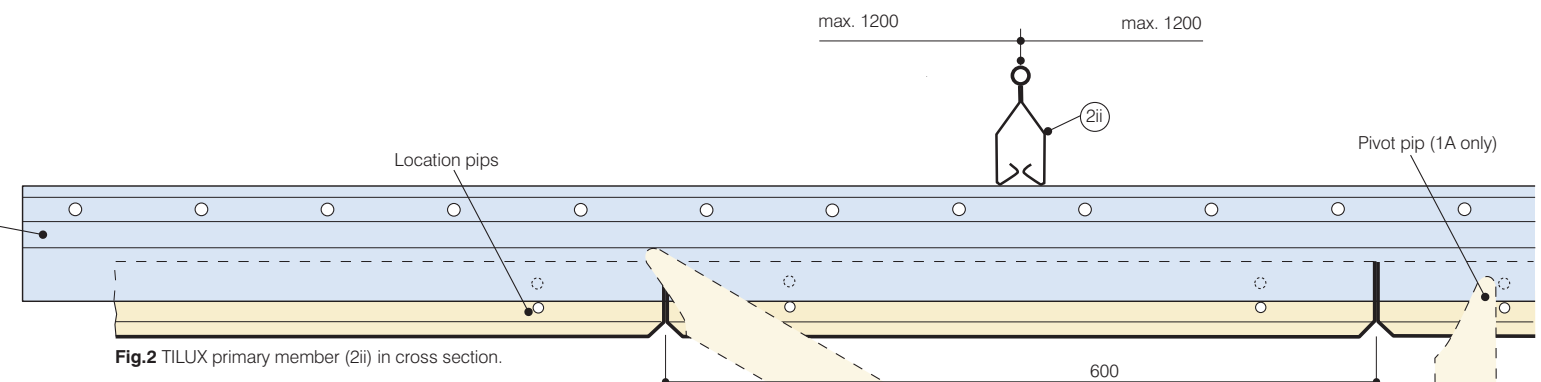

Fig.2 TILUX primary member (2ii) in cross section.

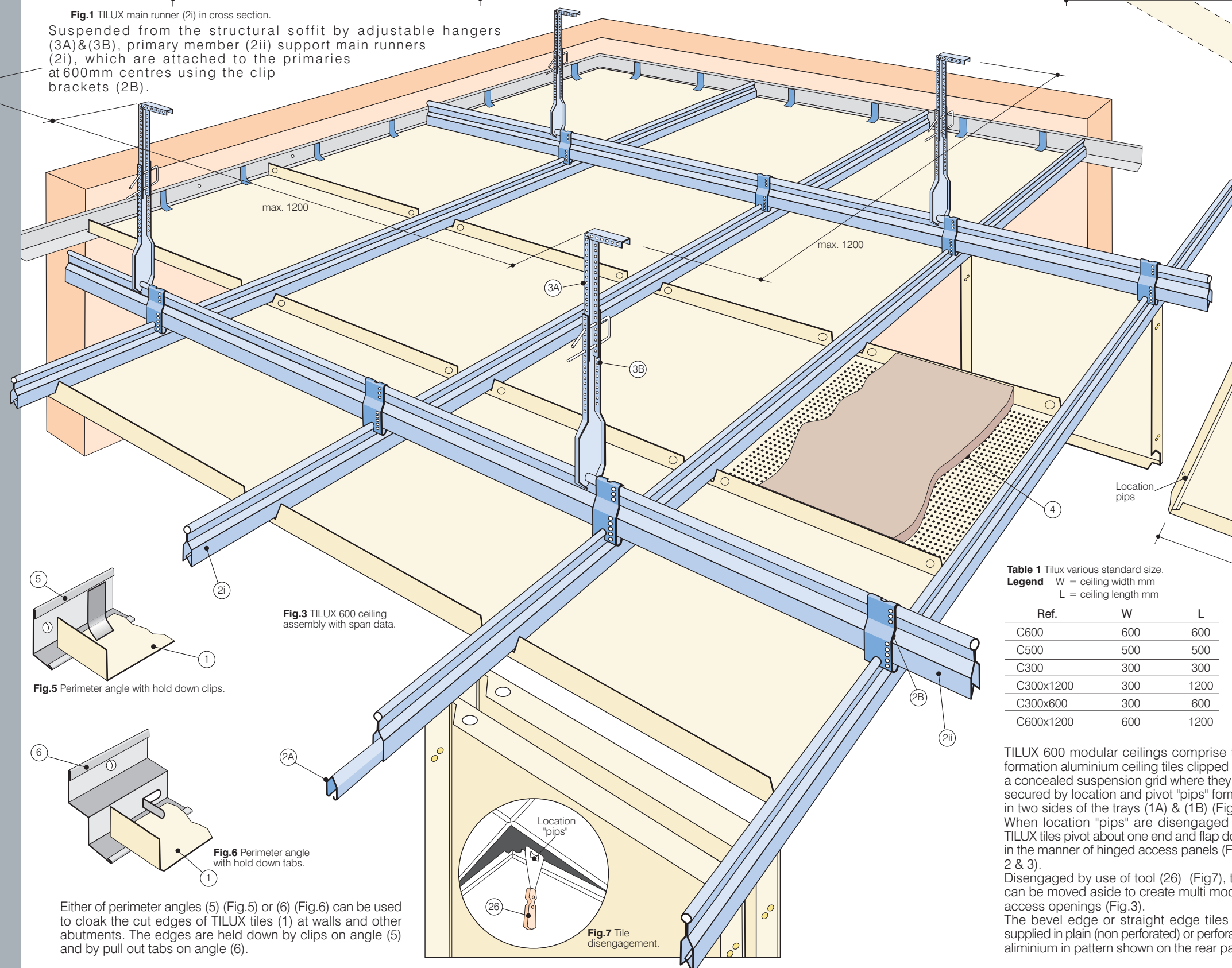

Fig.3 TILUX 600 ceiling assembly with span data.

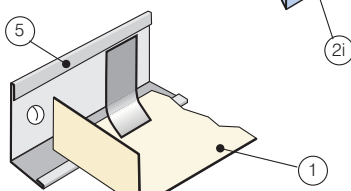

Fig.5 Perimeter angle with hold down clips.

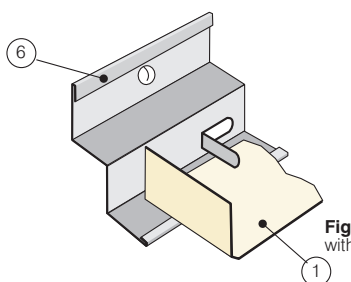

Fig.6 Perimeter angle with hold down tabs.

Either of perimeter angles (5) (Fig.5) or (6) (Fig.6) can be used to cloak the cut edges of TILUX tiles (1) at walls and other abutments. The edges are held down by clips on angle (5) and by pull out tabs on angle (6).

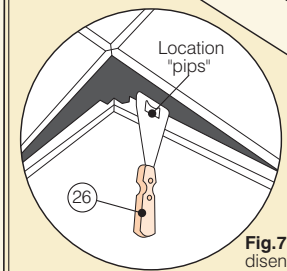

Fig.7 Tile disengagement.

"Pip" bearing sides of TILUX (1A) & (1B) are clipped into main runners and the tiles tight butted.

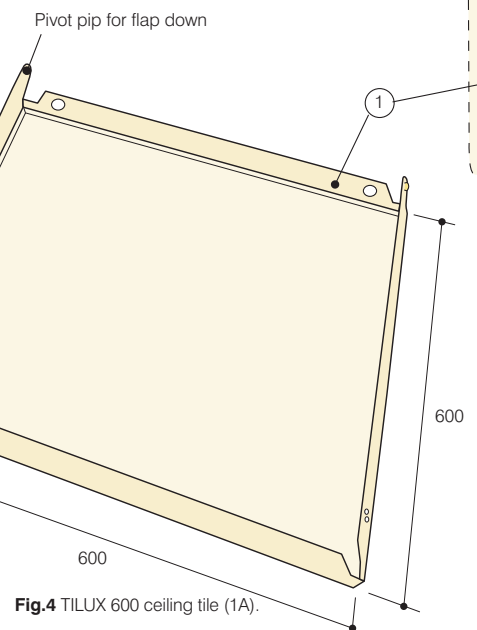

Fig.4 TILUX 600 ceiling tile (1A).

Table 1 Tilux various standard size.

Legend W = ceiling width mm
L = ceiling length mm

Ref.	W	L
C600	600	600
C500	500	500
C300	300	300
C300x1200	300	1200
C300x600	300	600
C600x1200	600	1200

TILUX 600 modular ceilings comprise tray formation aluminium ceiling tiles clipped into a concealed suspension grid where they are secured by location and pivot "pips" formed in two sides of the trays (1A) & (1B) (Fig.4). When location "pips" are disengaged the TILUX tiles pivot about one end and flap down in the manner of hinged access panels (Figs. 2 & 3). Disengaged by use of tool (26) (Fig.7), tiles can be moved aside to create multi module access openings (Fig.3). The bevel edge or straight edge tiles are supplied in plain (non perforated) or perforated aluminium in pattern shown on the rear page.

Available in white pre-coated stove enamel finish they can be supplied in special finished subject to minimum order quantity. Perforated TILUX tiles incorporating inert fibrous insulation pads (4) (Fig.3) are specified where a sound absorbent ceiling membrane is required. For thermal insulation purposes plain (non perforated) tiles with pads can be used.

TILUX ceilings can act as an air distributing system if air is allowed to flow from a pressurised ceiling plenum through holes in the tiles. Sealed insulation pads must be used in non active tiles. Specification details and test data are available on request.

