

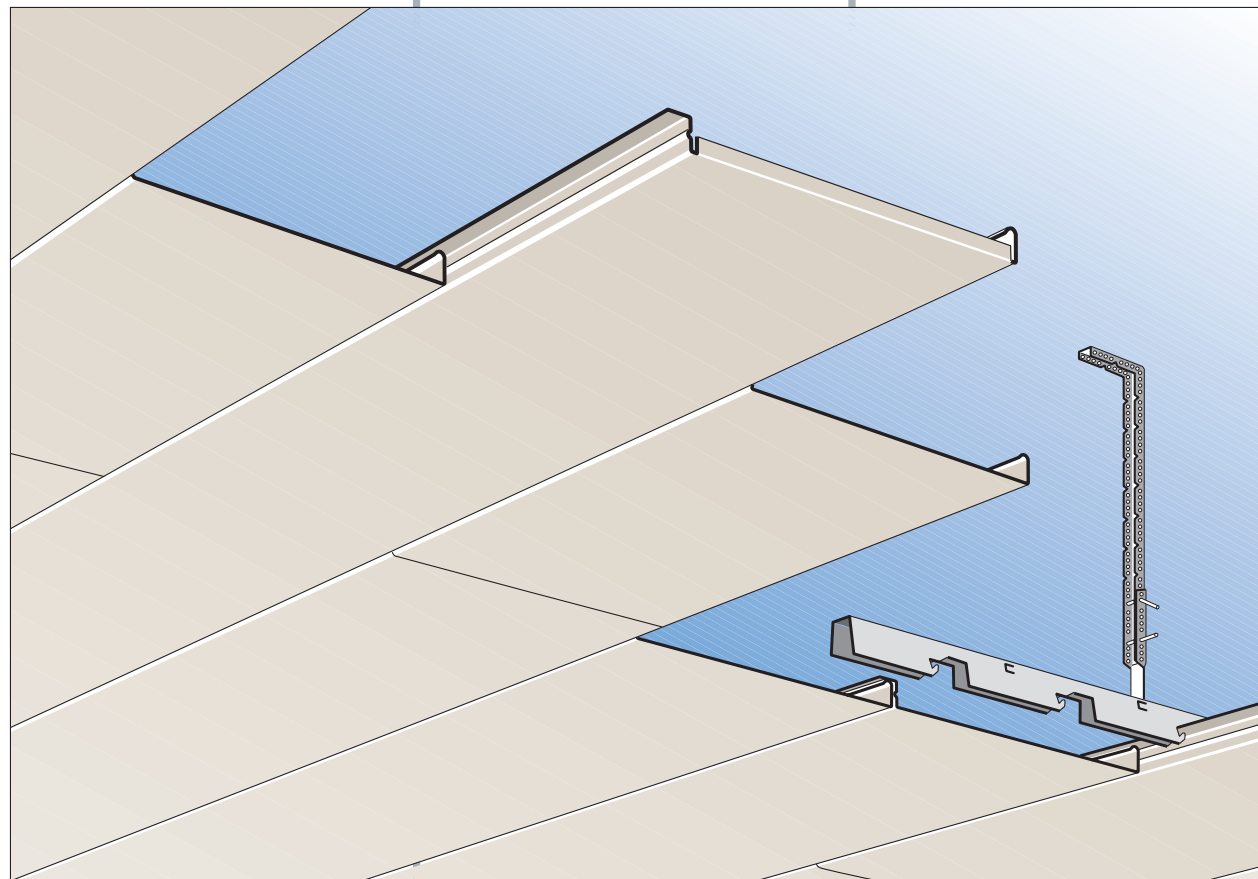

ShanghaiProfil

Fermulam F297H30-E

STRIP CEILING & CANOPY LINING
(side hung aluminium planks)



ShanghaiProfil Metal Ceiling Co., Ltd.
No. 30, Lane 1125, Nanliu Road,
Pudong New Area, 201300 Shanghai
P.R. China

Tel: (+86)-21-5803 3985
E-mail: info@shanghaiprofil.com
Fax: (+86)-21-5803 3990
Internet: www.shanghaiprofil.com

1

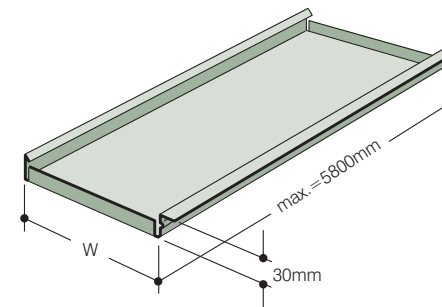

F297H30-E (W=297mm)
(Details of F197H30-E &
F147H30-E on application).

Cold roll formed 0.8mm thick
plain (non perforated)
aluminium.

Standard finish: stove enamel
semi gloss polyester paint.

Colours: standard white.

Special colours: subject to
minimum order quantity.

Standard length: 4000mm.

Ref.	W	H	Al
F147H30	147	30	0.6
F197H30	197	30	0.7
F297H30	297	30	0.8

2

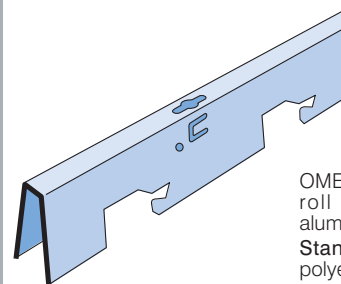

OMEGA HS 55 carrier in cold
roll formed 1.2mm thick
aluminium.

Standard finish: matt black
polyester stove enamel paint..

Standard length: 4000mm.
Overall size: 55mm deep x
30mm wide.

2A

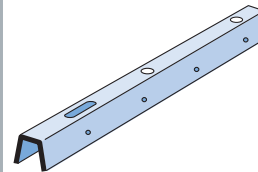

Channel coupler for OMEGA HS
55 carrier in 0.6mm thick
galvanised mild steel x 443mm
long.

Finish as carrier.
The 2 no's machine screws
shown to be supplied by
installer of system.

3

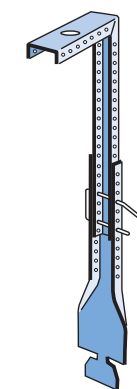

VERNIER hanger upper section
in 1.0mm thick galvanised mild
steel, paint finished, with 1.
25mm thick galvanised mild
steel bracket and 2.5mm dia.
steel looped security pin.

Standard length: 2000mm
upper section VERNIER hanger
has section edges vee notched
to provide 'easy break' positions
at 62mm centres.

4

Reference number allocation to
a component is based on its
function in the system, (4) refers
to thermal insulation which does
not feature in this publication.

5

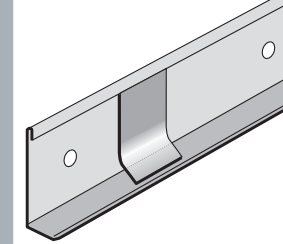

Perimeter angle trim in cold roll
formed 0.8mm thick aluminium
or extruded aluminium wallangle
in 2mm thickness.

Standard finish: white or black
semi gloss stove enamel
polyester paint.

Standard length: 4000mm.

Overall size: 40mm deep x
20mm wide.

6

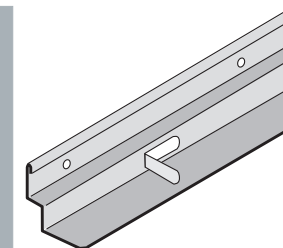

Perimeter shadow line angle trim
in metal, finish and lengths as
(5).

Overall size: 44mm deep x 36.
5mm wide. Shadow gap width
= 12.5mm

7

-

14

Reference number allocation to
a component is based on its
function in the system. No
FERMULAM F297H30-E
components suit 7-14
classification.

15

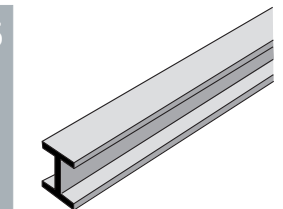

Extruded aluminium in 2mm
thickness.

Standard finish: stove enamel
semi gloss polyester paint.

Colours: to match F297H30-E
item (1).

Standard length: 4000mm.

Overall size: 35mm deep x
30mm wide.

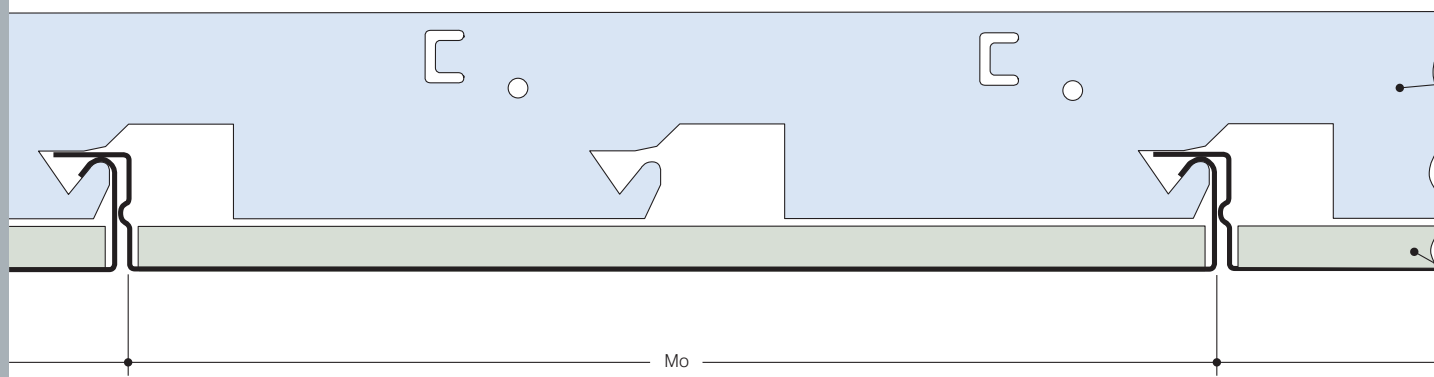

Fig.1 FERMULAM planks type F297H30-E (Mo=300mm) in cross section.

Suspended from the structural soffit by rigid adjustable hangers (3) (Fig.8) OMEGA HS 55 carriers (2) (Figs. 1, 2, 8) contain cutout features within which the sides of F297H30-E (1) planks are hung (Fig.1). The "restricted" throat of the cutout dictates that only after the "hook on" edge of planks has been engaged, must the

horizontal projecting leg (23mm wide) on adjacent planks be fed into its overlap position.

Butt jointed ends of planks must be aligned with an OMEGA HS 55 carrier (2) (Figs.3, 5) EXCEPT where bays constructed linings/ceilings are specified in which aluminium 'I' sections (15) (Fig.4) are

suspended from the structural soffit at plank length centres (ie. up to 5800mm) to support the ends of FERMULAM planks. Either of the perimeter angles (5) (Fig.7) or (6) (Fig.6) can be used to cloak the cut edges at walls and other abutments. The edges are held down by clips on angle (5) or by pull out tabs on angle (6).

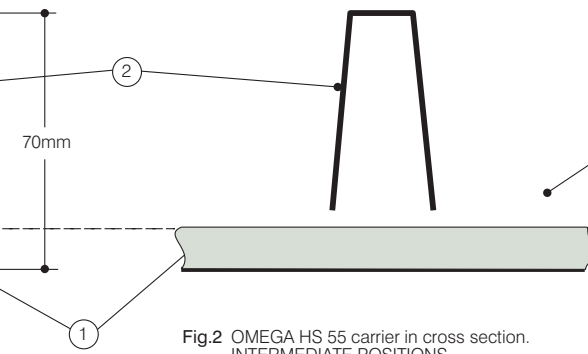

Fig.2 OMEGA HS 55 carrier in cross section. INTERMEDIATE POSITIONS.

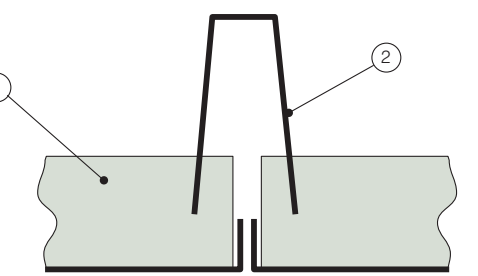

Fig.3 OMEGA HS 55 carrier in cross section. PLANK END ALIGNMENT.

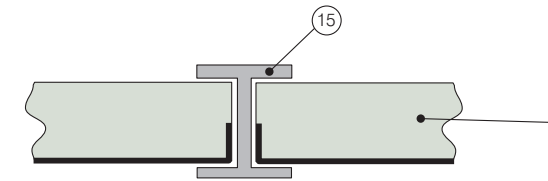

Fig.4 Ceiling bay separation 'I' section.

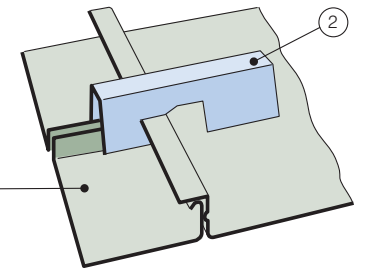

Fig.5 Close up view of PLANK END ALIGNMENT

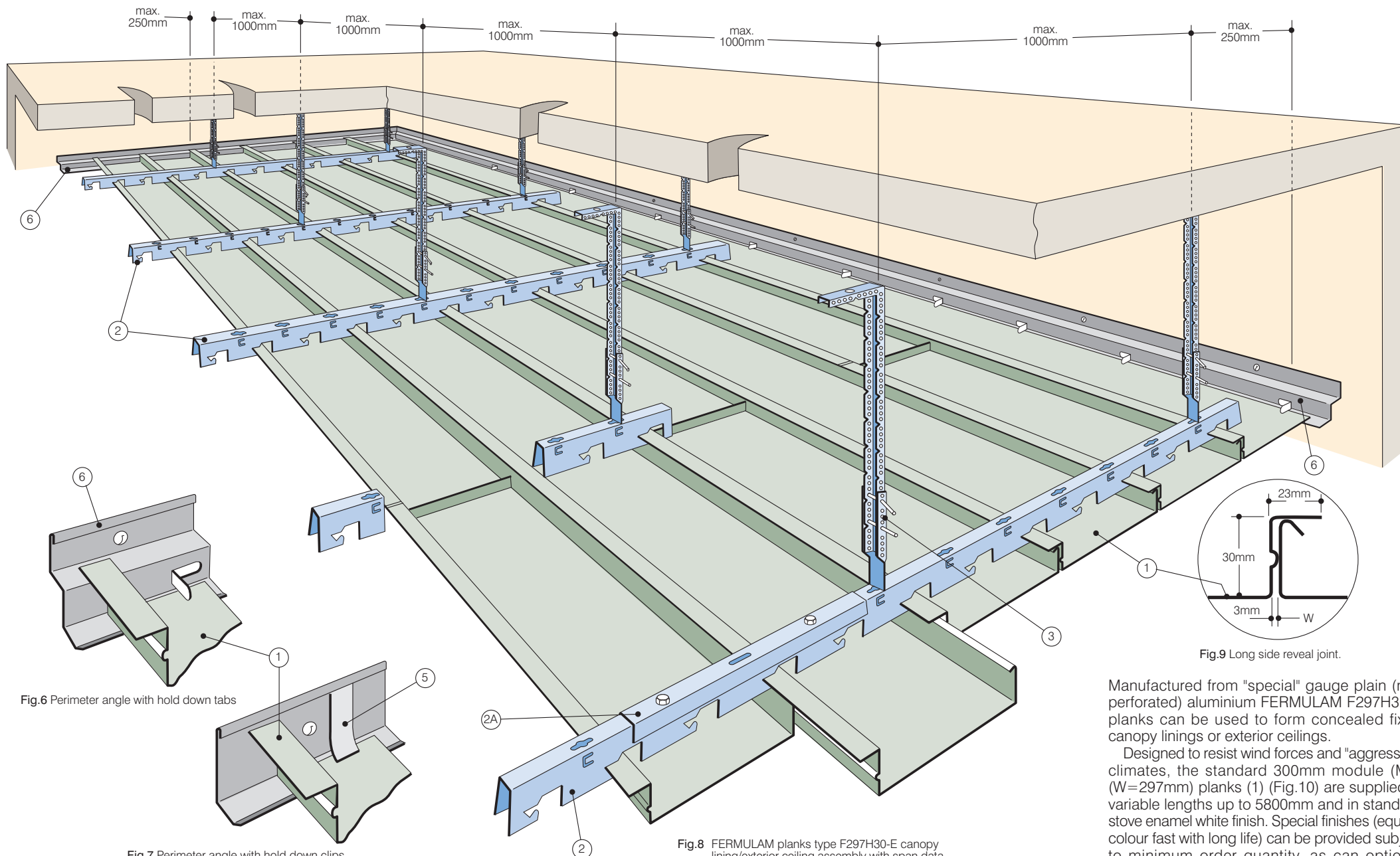

Fig.6 Perimeter angle with hold down tabs

Fig.7 Perimeter angle with hold down clips

Fig.8 FERMULAM planks type F297H30-E canopy lining/ exterior ceiling assembly with span data.

Fig.9 Long side reveal joint.

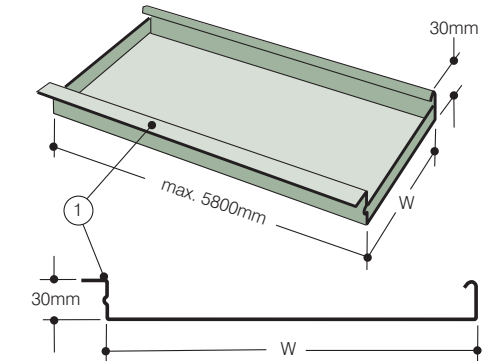

Fig.10 FERMULAM plank type F297H30-E.

modules of 200mm and 150mm (F197H30-E and F147H30-E respectively). Details of these can be obtained from the company.

The permanently captive (ie. non removable planks are side hung from Omega carriers (2) (Figs.1, 8) using a sequential 'hook on and overlap' fixing technique described opposite. 3mm wide continuous reveal joints are produced by a rib contained in the planks' side (Fig.9).

Their formed ends are butt jointed in line with Omega carriers in accordance with bonded or staggered joint principles. Alternatively the linings/ceilings can be divided into bays separated by an aluminium 'I' section as described opposite. See rear page for system component specifications.

Should access through the lining/ceiling be required local access panels are recommended.

Laboratory test data applicable to wind force and paint finish resistances are available on request.

Manufactured from "special" gauge plain (non perforated) aluminium FERMULAM F297H30-E planks can be used to form concealed fixed canopy linings or exterior ceilings.

Designed to resist wind forces and "aggressive" climates, the standard 300mm module (Mo) (W=297mm) planks (1) (Fig.10) are supplied in variable lengths up to 5800mm and in standard stove enamel white finish. Special finishes (equally colour fast with long life) can be provided subject to minimum order quantity, as can optional

**Fermulam
F297H30-E**